

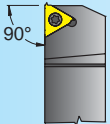

SER/L

PAG.A 71



**16ER/L
22ER/L**

∅ 16x16 - 32x32

ANR/L

PAG.A 71

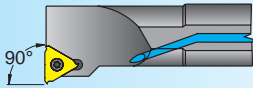

∅Dmin 12



**11NR/L
16NR/L
22NR/L**

A

Filettatura destra - Utensile destro
 Right threading - Right tool
 Rechtsgewinde - Rechte Ausfuehrung
 Filetage à droite - Outil droit

Filettatura sinistra - Utensile sinistro
 Left threading - Left tool
 Linksgewinde - Linke Ausfuehrung
 Filetage à gauche - Outil gauche

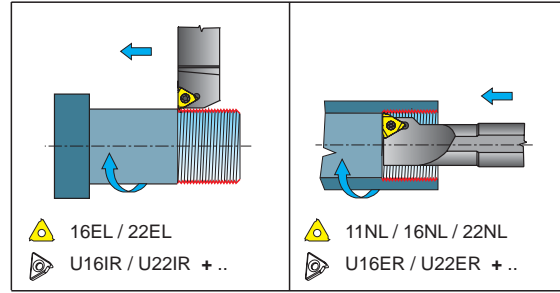
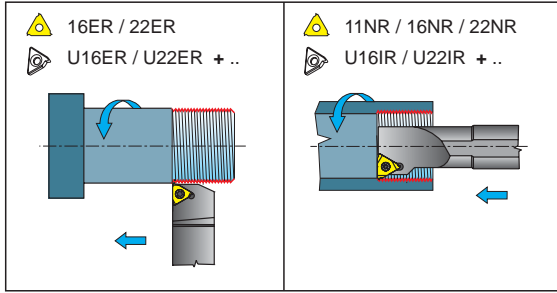

Sede - Seat - Sitz - Siège					
16	-	U16ER+3	U16ER+2	U16ER+1	U16ER
16	-	U16IR+3	U16IR+2	U16IR+1	U16IR
22	-	U22ER+3	U22ER+2	U22ER+1	U22ER
22	-	U22IR+3	U22IR+2	U22IR+1	U22IR

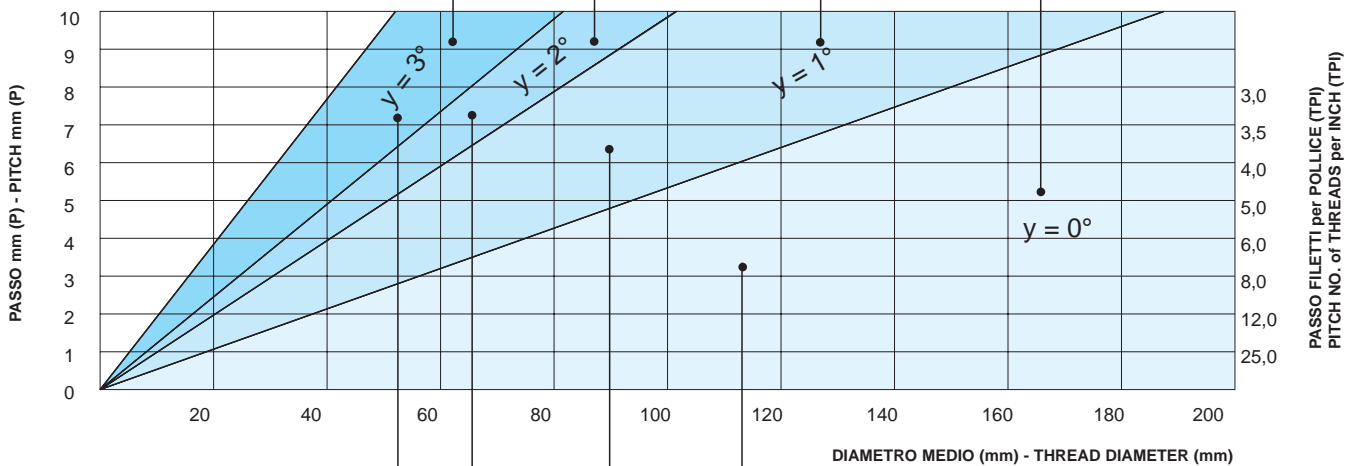
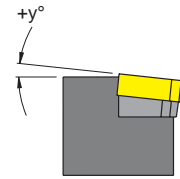

16	-	U16ER-3	U16ER-2	U16ER-1	U16ER
16	-	U16IR-3	U16IR-2	U16IR-1	U16IR
22	-	U22ER-3	U22ER-2	U22ER-1	U22ER
22	-	U22IR-3	U22IR-2	U22IR-1	U22IR

Sede - Seat - Sitz - Siège

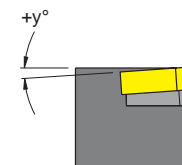

Filettatura destra - Utensile sinistro
 Right threading - Left tool
 Rechtsgewinde - Linke Ausfuehrung
 Filetage à droite - Outil gauche

Filettatura sinistra - Utensile destro
 Left threading - Right tool
 Linksgewinde - Rechte Ausfuehrung
 Filetage à gauche - Outil droit

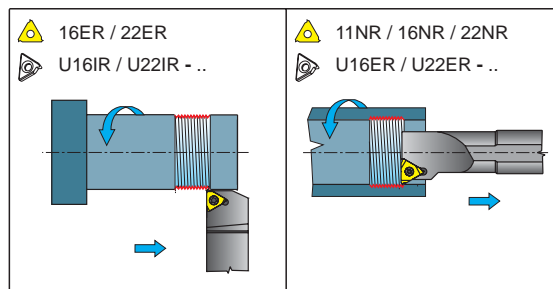
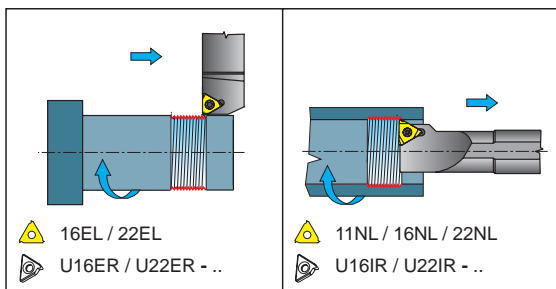

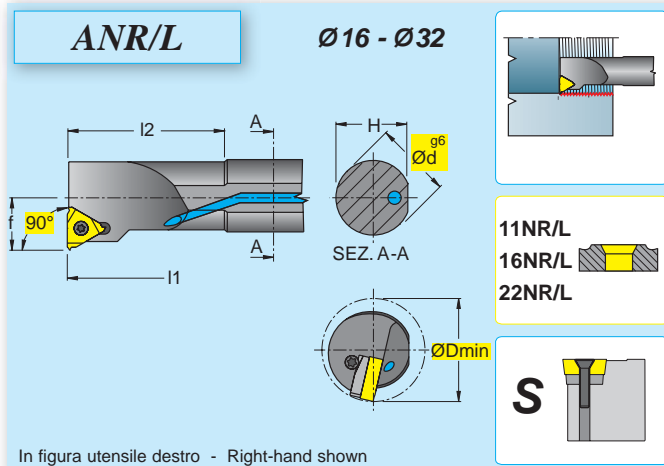
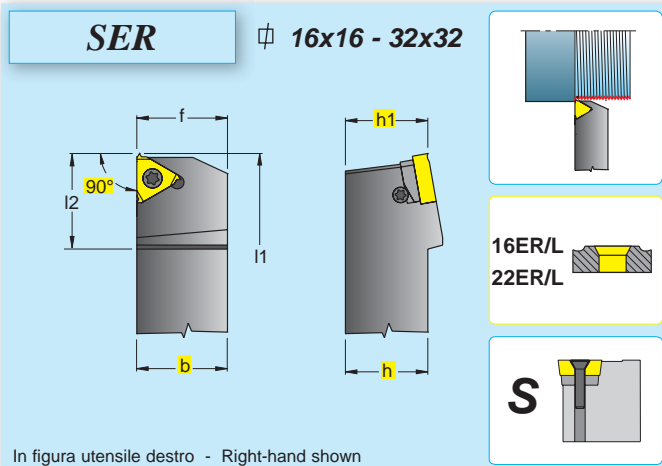

ART.	(mm)												
	h=h1	b	f	l1	l2	Nm			1	2	3	4	
SER/L 1616 H 16	16	16	16	100	25	1,8÷2,0	16ER/L	U16ER/IR	VS16T	S16T	5510		
SER/L 2020 K 16	20	20	20	125	27	1,8÷2,0							
SER/L 2525 M 16	25	25	25	150	29	1,8÷2,0							
SER/L 3225 P 16	32	25	25	170	29	1,8÷2,0							
SER/L 2525 M 22	25	25	25	150	29	2,5÷3,0	22ER/L	U22ER/IR	VS22T	S22T	5520		
SER/L 3232 P 22	32	32	32	170	29	2,5÷3,0							

ART.	(mm)												
	ØD	Ød	f	H	l1	l2	Nm		1	2	3	4	
ANR/L 0010 K 11	12	16	6,6	15,25	125	24,65	1,0÷1,2	11NR/L	-	-	12254P	5507P	
ANR/L 0013 L 11	15	16	8,2	15,25	140	32,00	1,0÷1,2						
ANR/L 0016 M 16	19	16	10,6	15,25	150	40,00	3,0÷3,5	16NR/L	-	-	123511P	5515P	
ANR/L 0020 Q 16	24	20	13,4	19	180	50,00	1,8÷2,0	16NR/L	U16IR/ER	VS16T	S16T	5510	
ANR/L 0025 R 16	29	25	16,3	24	200	55,00	1,8÷2,0						
ANR/L 0032 S 16	36	32	19,6	31	250	55,00	1,8÷2,0						
ANR/L 0020 Q 22	27	20	15,6	19	180	50,00	2,5÷3,0	22NR/L	-	-	S22T	5620	
ANR/L 0025 R 22	32	25	17,4	24	200	60,00	2,5÷3,0	22NR/L	U22IR/ER	VS22T	S22T	5620	
ANR/L 0032 S 22	39	32	21,5	31	250	60,00	2,5÷3,0						

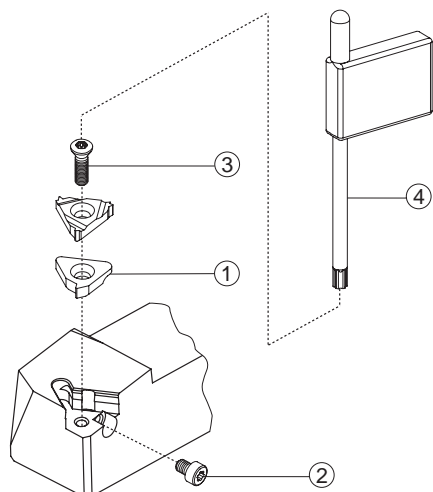

VELOCITÀ DI TAGLIO Vc
 Vc. CUTTING SPEED
 Vc. SCHNITTGESCHWINDIGKEIT
 Vc. VITESSE DE COUPE

ELENCO INSERTI
 INSERTS LIST
 WENDEPLATTENAUFLISTUNG
 LISTE DE PLAQUETTES

DETTAGLIO RICAMBI
 SPARE PARTS DETAILS
 DETAILS ZU DEN ERSATZTEILEN
 DÉTAIL DE PIÈCES DE RECHANGE

DATI TECNICI E CONSIGLI
 TECHNICAL DATA AND SUGGESTIONS
 TECHNISCHE DATEN UND EMPFEHLUNGEN
 DONNÉES TECHNIQUES ET CONSEILS

